

Technical Data

STAUFF RTF20 series return filters are designed as tank top filters with a maximum operating pressure of 10 bar (145 PSI) and flows up to 115 l/min (30 US GPM). The filter bowl is designed to return the oil beneath the surface thus preventing entrainment of air. RTF20 series compact design and integral breather make them ideal for mobile hydraulic applications.



Technical Specification

Construction	Tank top flange mounting	Integrated breather	Filter paper 10 or 40 µm
Filter head	Die cast aluminium	By-pass valve (integrated in the filter element)	Allows unfiltered oil to by-pass the contaminated element once the opening pressure has been reached Opening pressure 1.7 bar (25 PSI)
Element bowl and screw cap	Polyamide	Clogging indicators	Gauge indicator 0-6.9 bar (0-100 PSI) with colored segments Electrical, 0.35 - 2.5 bar (5-35 PSI) adjustable
Seals	"O"-Rings NBR (Buna-N®) FPM (Viton®)	Filter elements	Flow characteristics see page F83
Port connections	BSP, NPT, SAE "O"-Ring thread	Media	Mineral oils, other fluids on request
Flow rating	up to 115 l/min (30 US GPM) for 32 cSt (150 SUS) fluids		
Operating pressure	max 10 bar (145 PSI)		
Test pressure	min 24 bar (350 PSI)		
Temperature range	-25°C to +100°C (-13°F to +212°F)		

Dimensions

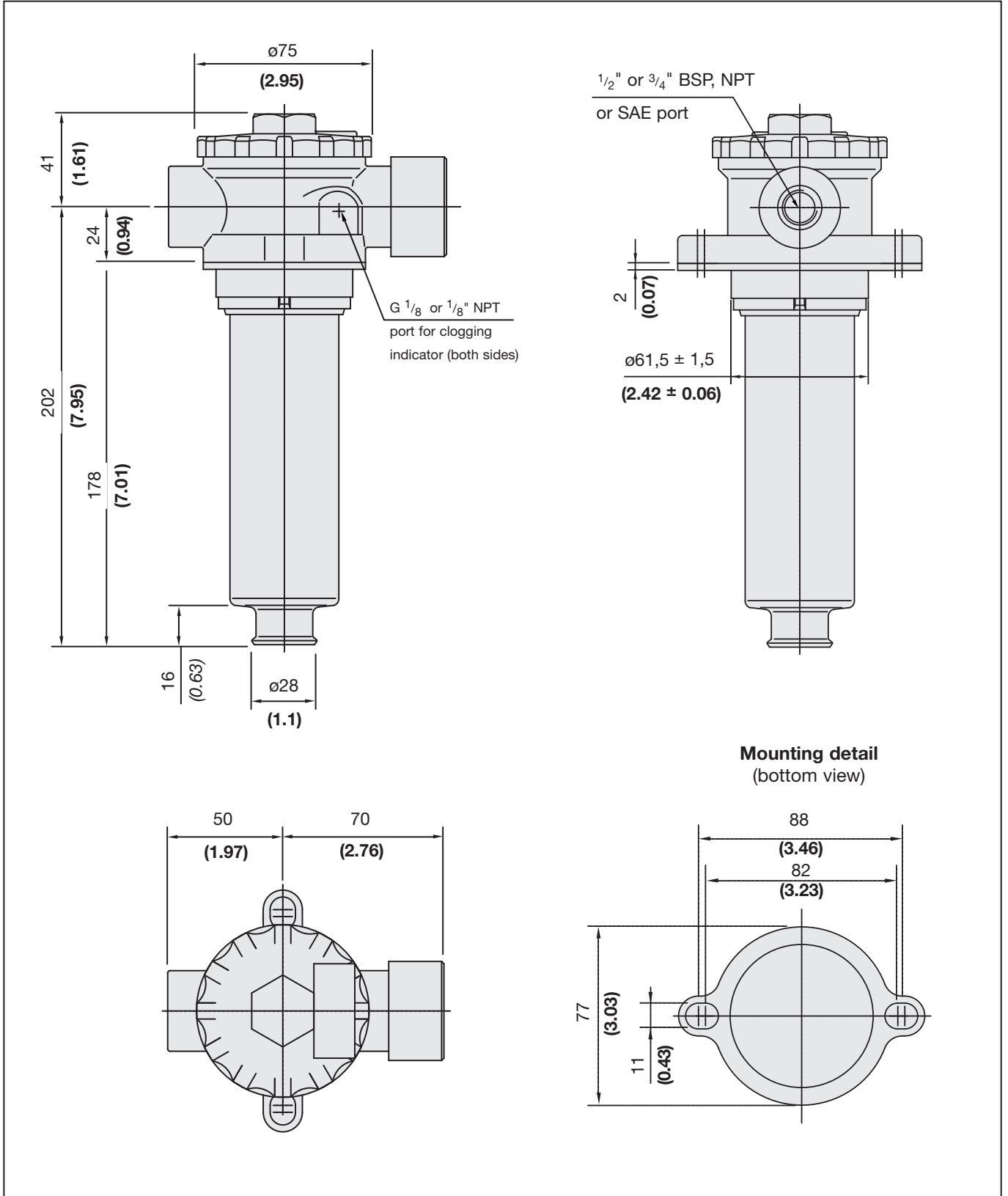

Dimensions in mm (inch)

Ordering Code Filter Housings

RTF20 N1 ... B V B10 D /X

Filter Type RTF20

Design Code
only for information

Connection Style		
Code	Connection Style	
B1	BSP	G 1/2
B2	BSP	G 3/4
N1	NPT	1/2
N2	NPT	3/4
S1	SAE- "O"- Ring Thread	3/4 -16 UN
S2	SAE- "O"- Ring Thread	1 1/16 -12 UN

Dipstick	
-	Without dipstick
D	Dipstick

For Complete Filters:
identification filter material
+ micron rating code
(see ordering code filter elements below)

Breather	
B10	10 µm Filter paper
B40	40 µm Filter paper

Clogging Indicator	
N	without clogging indicator
V	visual
E	electrical

See page F88 for more details on the indicator options.

Seal Material	
B	NBR (Buna-N®)
V	FPM (Viton®)

FILTRATION

Ordering Code Filter Elements

RTE20 D 10 B /X

Series RTE20

Design Code
only for information

Filter Material		
Code	Material	Micron ratings available
D	Filter paper	10
G	Inorganic glass fiber	6,10,20

Seal Material	
B	NBR (Buna-N®)
V	FPM (Viton®)

Micron Rating	
Code	Rating
06	6 µm
10	10 µm
20	20 µm

Flow Characteristics

The following characteristics are valid for mineral based fluids with a density of 0,85 kg/dm³ and the kinematic viscosity of 30 mm²/s. The characteristics have been determined in accordance to ISO 3968. Multipass filter ratings have been obtained in accordance to ISO 16889. Consult factory for details.

